



MAKEOVER NEWS

SUMMER/FALL 2004

WORK PROGRESSES ON THE MAKEOVER OF THE CENTURY

Westfield Shoppingtown Century City continues work on *The Makeover of the Century*, a two-year \$127 million redevelopment and expansion of Westfield Shoppingtown Century City to make shopping better for you.

The redevelopment will solidify Westfield Shoppingtown Century City as the premier shopping, dining and entertainment venue in West Los Angeles.

Highlights of the project include a state-of-the-art 15 screen AMC Theatre complex with stadium seating and digital surround sound opening in a new location Fall 2005, a new and expanded alfresco style food court opening Fall 2005, the addition of approximately 63,000 square feet of new retail, an expanded and renovated Gelson's The Super Market, the ultimate in fashion for you and your home and more fabulous dining selections.

The project also includes a façade facelift on Santa Monica Boulevard to better integrate the Shoppingtown with the Santa Monica Boulevard Beautification Project being constructed by the City of Los Angeles. The \$68 million beautification and expansion project on Santa Monica Boulevard will enhance the visibility and make access to the Shoppingtown more convenient.

We are thrilled to have begun this redevelopment, which will meet the growing needs of our shoppers and community. The redevelopment will solidify Westfield Shoppingtown Century City as the premier shopping, dining and entertainment venue in West Los Angeles. Get ready for *The Makeover of the Century*, as we pave the way for a bigger and brighter Westfield Shoppingtown Century City!



MAKING SHOPPING
BETTER FOR YOU



DEVELOPMENT UPDATE

PARKING

- The existing parking entrance towards the west side of Constellation Boulevard leading to Gelson's The Super Market and the Shoppingtown as well as the Gelson's open lot have closed to allow excavation work to commence on the site that will be the new 15 screen AMC Theatre. A new temporary entrance to Gelson's and the parking garage has been opened approximately 100 feet east on Constellation Boulevard.
- The Century Park West entrance and exit will close for a few days in mid-August in preparation for structural steel overbuild to support a second level.

ACCESS

- Customers requiring access to Gelson's and the Shoppingtown garage should now enter and exit through the new temporary entrance on Constellation Boulevard. Pedestrians should enter the Shoppingtown via Macy's and access Gelson's via the escalators next to Tourneau.
- Access to the parking garage from Century Park West has changed. Traffic will be temporarily directed to level A only.

CONSTELLATION BOULEVARD

- The sidewalk on the north side of Constellation Boulevard has closed in order to create a new entrance to level A of the parking garage. As a result, the bus stop on Constellation Boulevard has temporarily closed. Please use the bus stop located on the northwest corner of Constellation Boulevard and Avenue of the Stars.

DEMOLITION

- Demolition work on the two existing retail buildings on the west side of the Shoppingtown between Gelson's and Macy's is now complete.

COLUMN REINFORCEMENT

- Over half of the 150 columns in the parking garage that required strengthening to support the second level of retail have also been completed. The remaining column work will continue over the next few months as work begins on preparing the first level of retail for steel erection later this year. To facilitate this work, several retailers have temporarily relocated within the Shoppingtown (Coach, The Body Shop, Horton & Converse Pharmacy, Shoe Wiz, Century City Optometry and Great Earth Vitamins). Please visit the Shopping Concierge Center for up-to-date retailer locations.

WAY FINDING

- Directional signage is in place at all locations to ensure your shopping trip remains easy and convenient. Follow the diamonds, located on the floor throughout the Shoppingtown, to our fine collection of retailers.



CONSTRUCTION

- The shade structure in center court has been removed in order to construct a second level of retail and a new center design. Our construction team has started the process to remove the roof overhang and to demolish the building where The Body Shop, Via Spiga and Panda Express were located.

MANAGEMENT OFFICE

- The Shoppingtown Management Office has relocated. Please visit us in our new location on Santa Monica Boulevard adjacent to New York Deli. From Gap take the escalator down and follow the red arrows.

RETAILER RELOCATION

- Many of our retailers have temporarily relocated within the Shoppingtown. Please see our Shopping Concierge for up-to-date listings and retailer locations.

POST OFFICE

- Please note that due to federal security guidelines, the US Post Office was unable to secure a temporary location. The Post Office has closed for a few months and will re-open in their new space just in time for the holiday season. During this time please feel free to utilize the Shopping Concierge Center for outgoing mail. For alternate postal locations please see a Shopping Concierge.
- For your convenience we have established a scheduled stop by the "Post Office on Wheels". This mobile unit will provide service to Westfield Shoppingtown customers as well as all high rise building employees within the area. Visit the mobile unit, located on Santa Monica Boulevard next to the Management Office adjacent to New York Deli, for all your mailing needs. Hours of service are Monday, Wednesday and Friday from 10:00am to 12:30pm.

For more information on the Makeover please visit www.westfield.com or call the Redevelopment Hotline at 877-276-7000

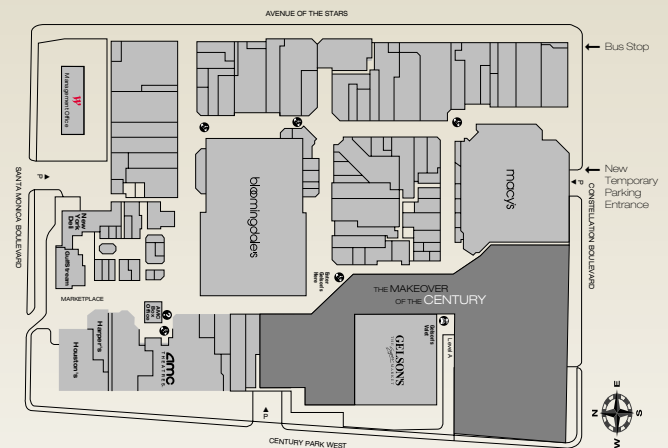

VALET PARKING

Take advantage of our valet parking service located on Santa Monica Boulevard and on level A of the parking garage next to Gelson's The Super Market. Valet is complimentary with any purchase at Gelson's.



MESSAGE FROM OUR GENERAL MANAGER

The excitement builds as the framework for our renovation and expansion takes shape in the coming months. Keep in mind that while we are building our new Shoppingtown, our fine selection of retailers are open for business with stores such as Gelson's, Tiffany & Co., Riginals, Gulfstream, Charles David and Tourneau. In addition, we are excited to announce that BCBG Max Azria, Papyrus, Swarovski and Baby Gap/GAP Kids are all under construction and scheduled to open later this year. This, together with the completion of the current phase of the Santa Monica Boulevard construction work in front of the Shoppingtown in August, will help facilitate easy access to the center through the rest of the year. My team looks forward to making shopping better for you during your next visit to our Shoppingtown.

Sincerely,



Paul Kurzawa

October 27-30, 2004

CENTURY CITY'S FILM FESTIVAL TAKES THE BEST AND ALL THE REST!



We're the only festival of it's kind! Have a film that screams "Oscar?" Or one that all your friends say should have headlined at Sundance or Toronto? Submit it! Created a "B" movie? How about a campy one? Or what about a

"Blaxploitation" or "Silent" film? Submit those too!

We're looking for the unusual, the fun, and the daring for this category! We'll screen the top "traditional" indies and the top "B movie/non-traditional" indies. The two top films from each category will compete head-to-head for the top Audience Award.

The festival is the brain child of Patrice Williams, the founder of "The Broadcasting Training Program," a non-profit organization formed to provide training opportunities to college graduates in film production, radio and television news reporting and news management. Proceeds will go to support the organization.

For more information go to:

www.CenturyCityFilmFestival.com, or call 310-551-1035 or 877-7-CENTURY.

GIFT CARDS

Looking for the perfect gift? The Westfield Shoppingtown Gift Card is the perfect fit everytime and can be used at Westfield Shoppingtowns nationwide at any store that accepts the American Express card. It comes beautifully packaged with a complimentary greeting card. The gift that's sure to be a hit everytime!



WHAT'S NEW

Now Open...

Riginals	310-557-2532
Puzzle Zoo Toys	310-284-8268
Wholly Crepe	310-785-0177
Ann Taylor Loft	310-557-1293

Specialty Carts...

Apple iPod Cart	Speed
Gold & Silver Jewelry	Game World
Table Top	discgear
Bangkok Imports	Herbal Comfort
Digital Sculptures	3D WOOD
Mountain View Environmental	

Coming Soon...

Papyrus	Opening Fall 2004
Swarovski	Opening Fall 2004
Wetzel's Pretzles	Opening Fall 2004
Gap Kids/Baby Gap	Opening Winter 2004
Apple	Opening Winter 2004
Limited Too	Opening 2005
The Container Store	Opening 2005
Williams-Sonoma Home	Opening 2005

AMC THEATRES®

Look for the new state-of-the-art AMC Theatre complex featuring:

- Stadium Seating
- Extra Wide Seats
- Wall-to-Wall Screens
- A Custom Interior Design
- Two Theatre Levels
- Expanded Leg Room
- Digital Surround Sound

OPENING FALL 2005

GELSON'S THE *Super* MARKET

Gelson's will be expanding their selection and adding 4,000 square feet. The store will be closing at the end of September for approximately two weeks due to the construction work of Gelson's and the Shoppingtown. Improvements to the store will include new freezer cases, a new wine rack system and a new beverage cooler. They will remain open throughout the rest of *The Makeover of the Century*. We appreciate your patience as we continue to enhance your shopping experience. Look for an expanded and relocated service deli, bakery and coffee bar in 2005. For more information please call 310-277-4288.

HOW TO CONTACT US

-  Shopping Concierge Center 310-277-3898
-  Management Office 310-553-5300
- Security and Lost & Found 310-551-0212
- Redevelopment Hotline 877-276-7000

centurycity@westfield.com

SHOPPINGTOWN HOURS

Monday through Saturday: 10:00am – 9:00pm
Sunday: 11:00am – 6:00pm
Department Stores and Holiday Hours may vary

SANTA MONICA BOULEVARD TRANSIT PARKWAY PROJECT UPDATE

The Santa Monica Boulevard Transit Parkway Project commenced work early last year. The project has a projected completion date of early 2006.

The Santa Monica Boulevard Transit Parkway Project is the reconstruction and reconfiguration of 2.5 miles of Santa Monica Boulevard between I-405 on the west (Beloit Avenue) and the Beverly Hills city limit on the east (Moreno Drive). The new boulevard will have three eastbound and three westbound travel lanes. Neighborhood access roads on the north and south sides of the main road are planned. The project will include a new street lighting and traffic signal system, a landscaped median, bicycle lanes and bus priority features. Additionally, the on-ramps to the northbound and southbound I-405 Freeway will be improved by adding High Occupancy Vehicle (HOV) bypass lanes onto the freeway.

For daily Santa Monica Boulevard Project traffic updates and night work, please call the Santa Monica Boulevard Project Traffic Update Hotline at 310-785-2300 ext. 202. It is updated daily, and provides the latest information on lane closures, detours and night work.



MANAGEMENT TEAM

General Manager
Paul Kurzawa
Assistant General Manager
Keitha Mills
Marketing Director
Najla Tabbah
Regional Assistant Marketing Manager
Lindsay Lebby
Specialty Leasing Managers
Carole Caplan
Mary Ostroff
Property Accountants
Angie Guinan
Elliot Rousso
Administrative Assistant
Lucy Cisneros
Receptionist
Taling Rutledge
Director of Security
Vurne Bobbs
Chief Engineer
Ray Cebrían
Parking Manager
Javier Aguayo
Housekeeping Manager
Arnulfo Nunez
Sr. Shopping Concierges
Tonia Hogan
Nicholas Martinez

COMPLIMENTARY W SIGNATURE GIFT BOX

Present \$100 in same day receipts at the Shopping Concierge Center for your complimentary Westfield Signature Gift Box.



Just one less thing for you to worry about when shopping for a gift. Westfield Signature Gift Boxes come in a variety of sizes and come tied with a beautiful ribbon. See a Shopping Concierge for details.

W GET READY TO UNWIRE



Bring your wireless enabled PC or PDA and this newsletter to the Shopping Concierge Center for your complimentary

wireless day pass to take advantage of our wireless internet technology.

Westfield Shoppingtown Century City is now a wireless hotspot. If you have a notebook PC or PDA with Intel Centrino mobile technology, the service offered here is compatible with your system. Westfield Shoppingtown Hotspots are designed to help you stay connected and productive when you're on the go. Visit the Shopping Concierge Center to pick up a complimentary day pass and discover the convenience of wireless access.

W SHOPPING CONCIERGE SERVICES

Visit our Shopping Concierge Center for assistance with all your shopping needs. They are there to make your shopping trips more convenient and enjoyable so that you feel special and appreciated each time you visit.

Services and amenities include:

- Personal Shopping Assistance
- Gift Suggestions
- Retailer Information
- Reservations
- Complimentary Signature Gift Box
- Complimentary Package Carry-Out
- Expectant Mother Parking
- Valet Parking
- Wireless Hotspots
- Car Wash
- Shoe Shine
- Notary Services
- Complimentary Shopping Bags
- Complimentary Kiddie Kruzzler Strollers
- Complimentary Balloons
- Westfield Gift Cards



Need help with something not listed? Just ask. We're here to help!